

NAVIHALTERUNG

Navigation bracket | Soporte para GPS | Support pour système de navigation | Supporto per navigatore

Art.-Nr.: **21097-202 orig. Navi.** / orig. navigation system

Art.-Nr.: **21097-302 Universal** / universal

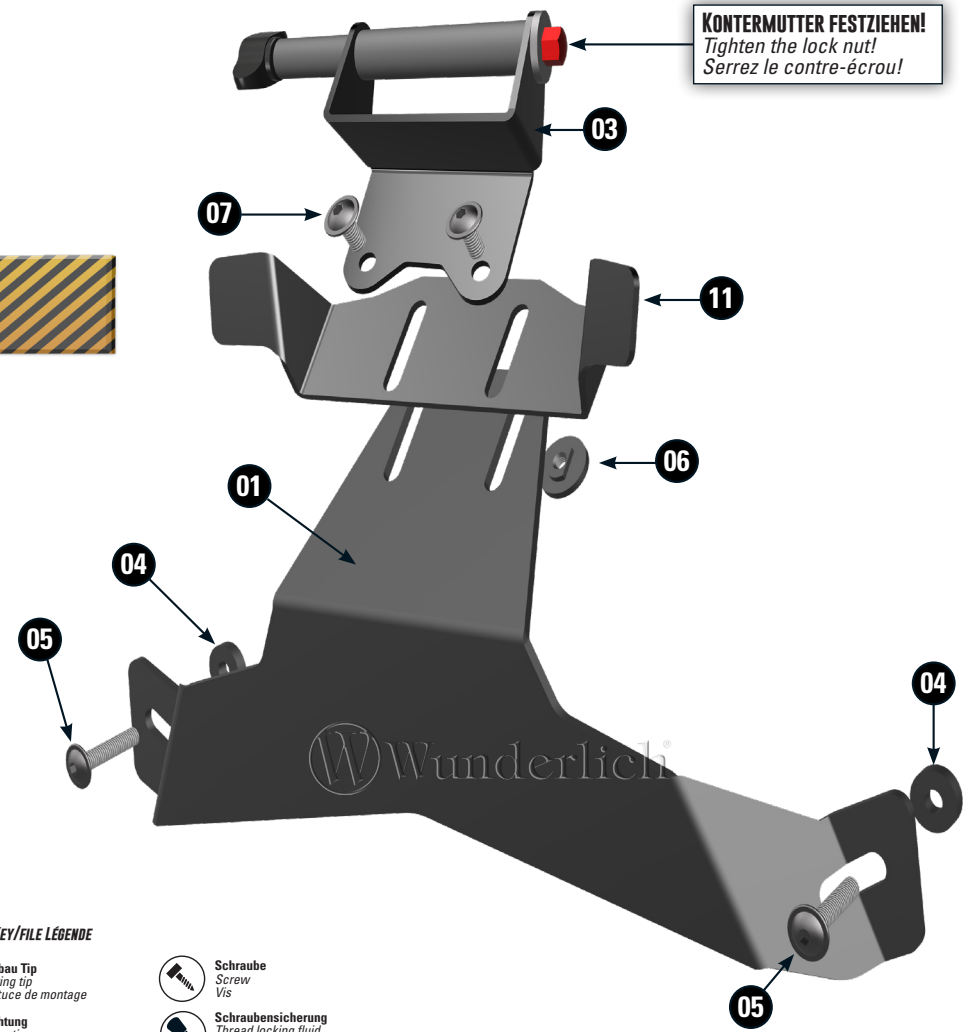
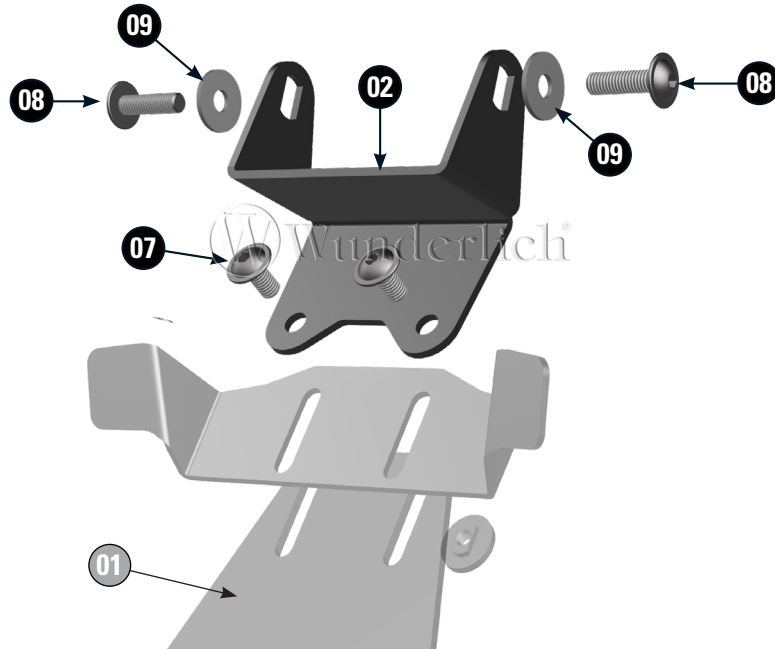

#	BEZEICHNUNG / DESCRIPTION	DE EN	FR	DIN	ISO	MENGE QUANTITY
1	Grundhalter / base bracket					1
2	Halter orig. Navi / bracket orig. navigation system					1
3	Halter Universal / universal bracket					1
4	Distanzhülse / sleeve	ØD 14,5 / Ød 5,5 / h 4,0mm				2
5	Linsenflanschschraube / lens head screw	M5x25		7381SA2	7381SA2	2
6	Einlegemutter / insert nut					2
7	Linsenflanschschraube / lens head screw	M5x10		7381SA2	7381SA2	2
8	Linsenflanschschraube / lens head screw	M5x18		7381SA2	7381SA2	2
9	U-Scheibe / washer	M5		9021SA2	7093	2
10	Klebeband doppelseitig / double-sided tape					4cm
11	Verstärkungsblech / reinforcing plate					1

LEGENDE/KEY/FILE LEGENDE

- Anbau Tip / Fitting tip / Astuce de montage
- Achtung / Attention / Attention
- Vergrößerung / Magnification / Grossissement

- Schraube / Screw / Vis
- Schraubensicherung / Thread locking fluid / Freiniflets
- Drehmoment / Torque

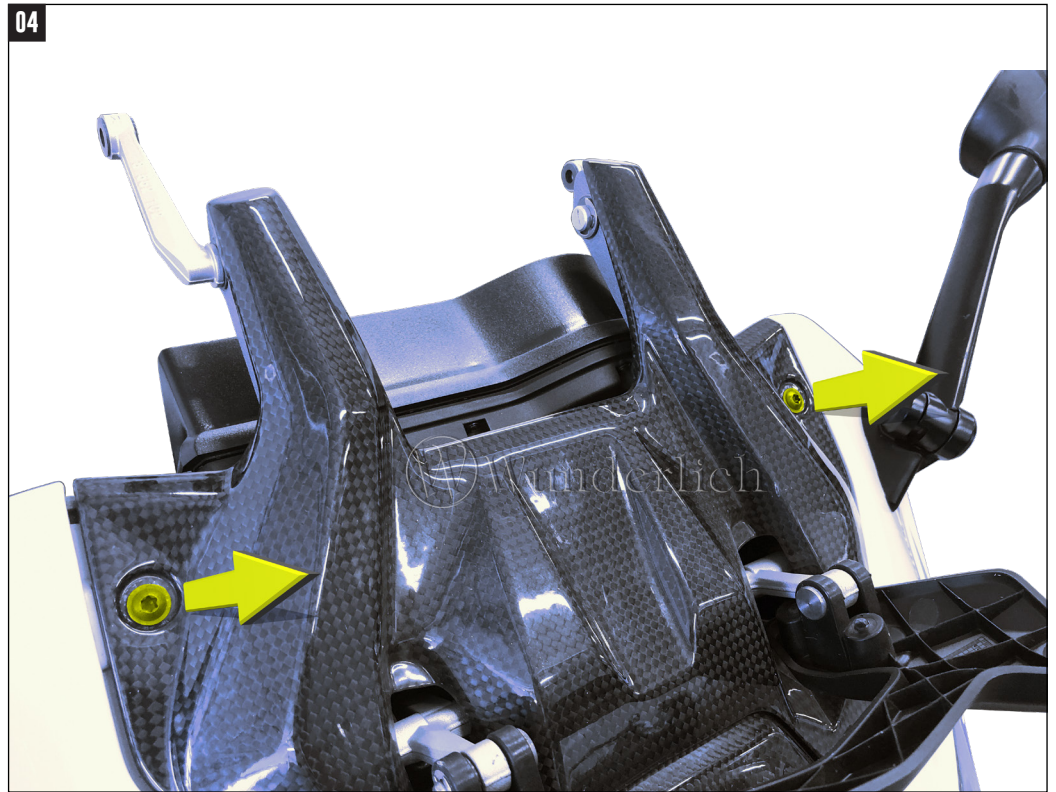
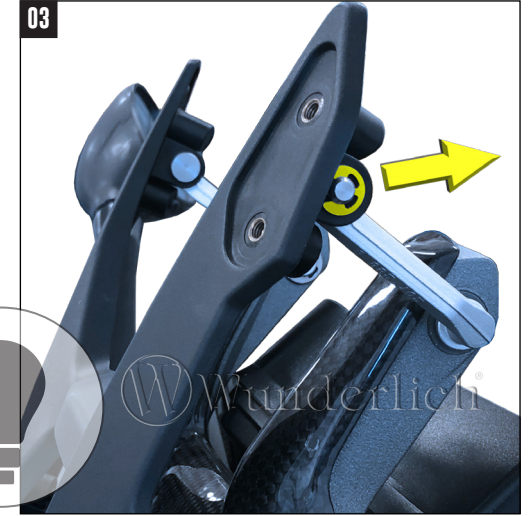

05

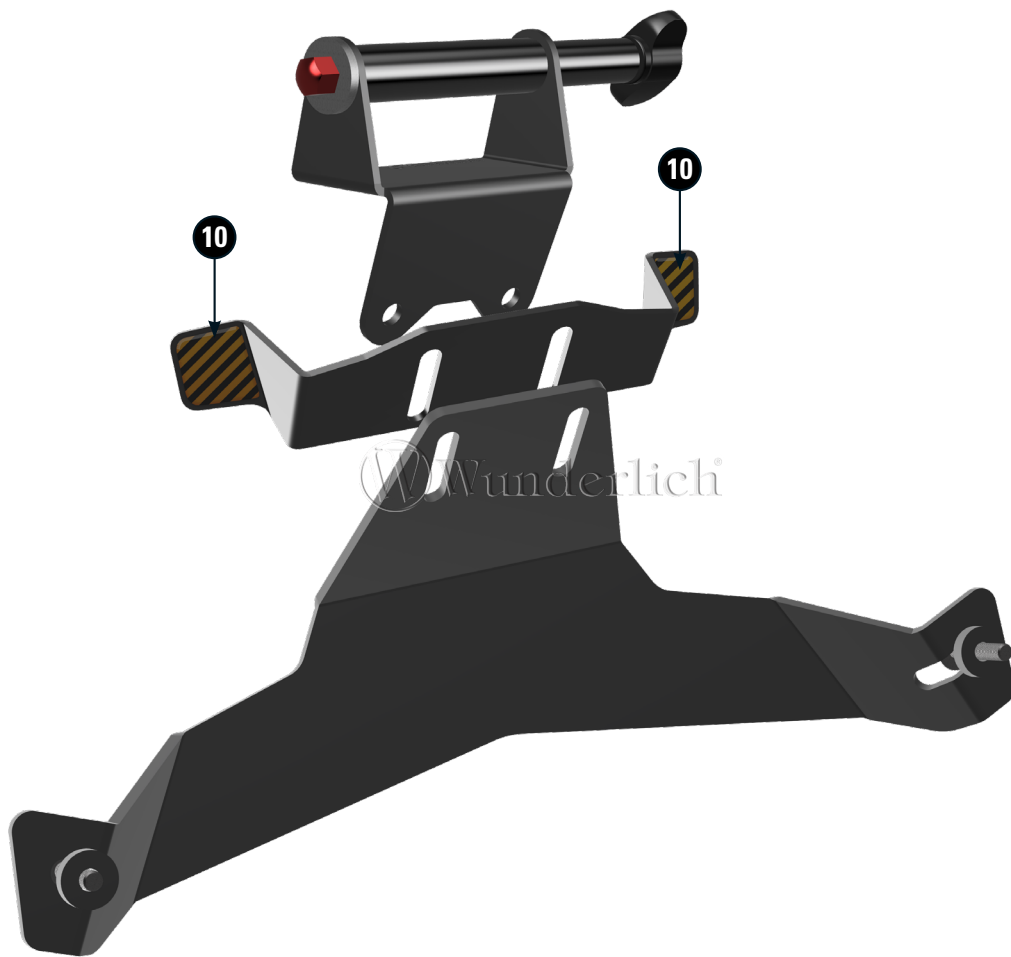

06

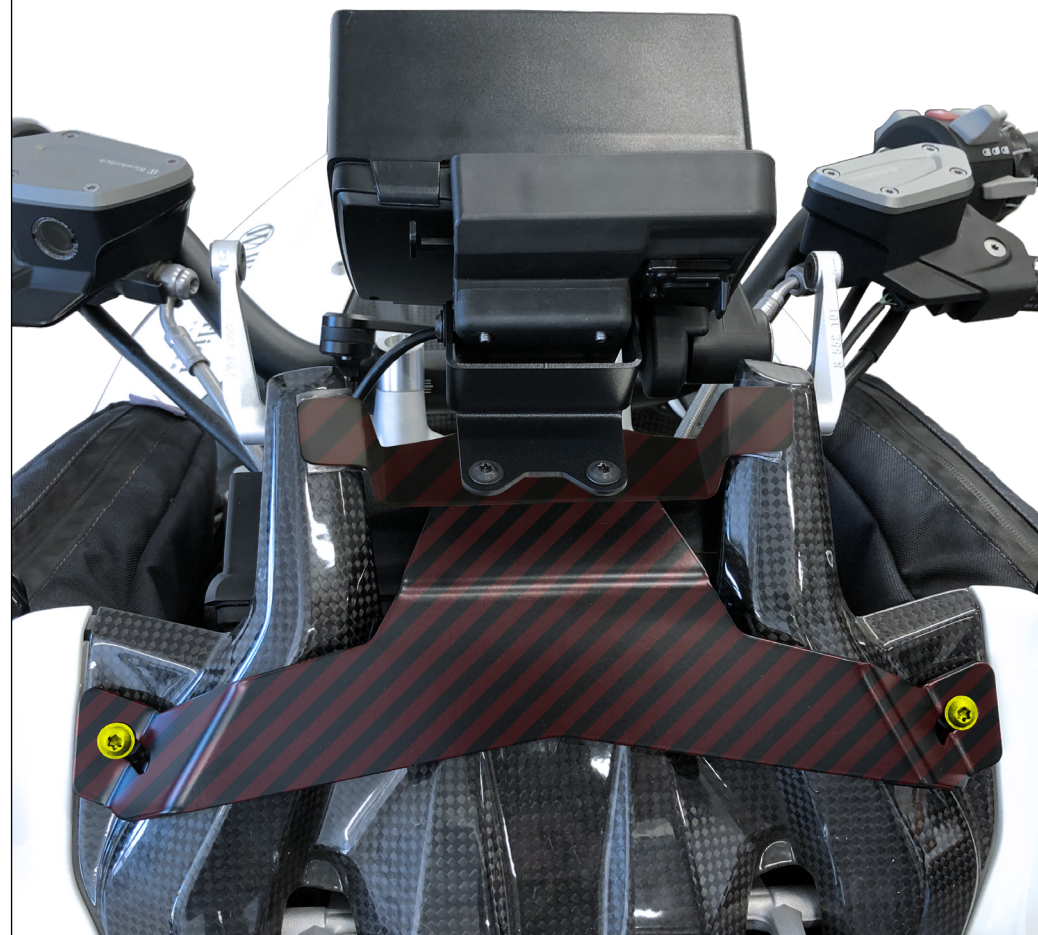

07



08

SP-CONNECT ADAPTER OPTIONAL. FLÜGELMUTTER BEIDSEITIG MONTIERBAR.
 SP-Connect adapter optional. Wing nut mountable on both sides.
 Adaptateur SP-Connect en option. Ecrou à oreilles montable des deux côtés.



09

